

# **H-ESY Series Inverter**

## **Quick Installation manual**

## 1 Installation Requirement

When installing the inverter, a certain amount of space must be reserved around it to ensure that there is sufficient room for installation, maintenance and heat dissipation. The recommended installation height is 1500 mm.

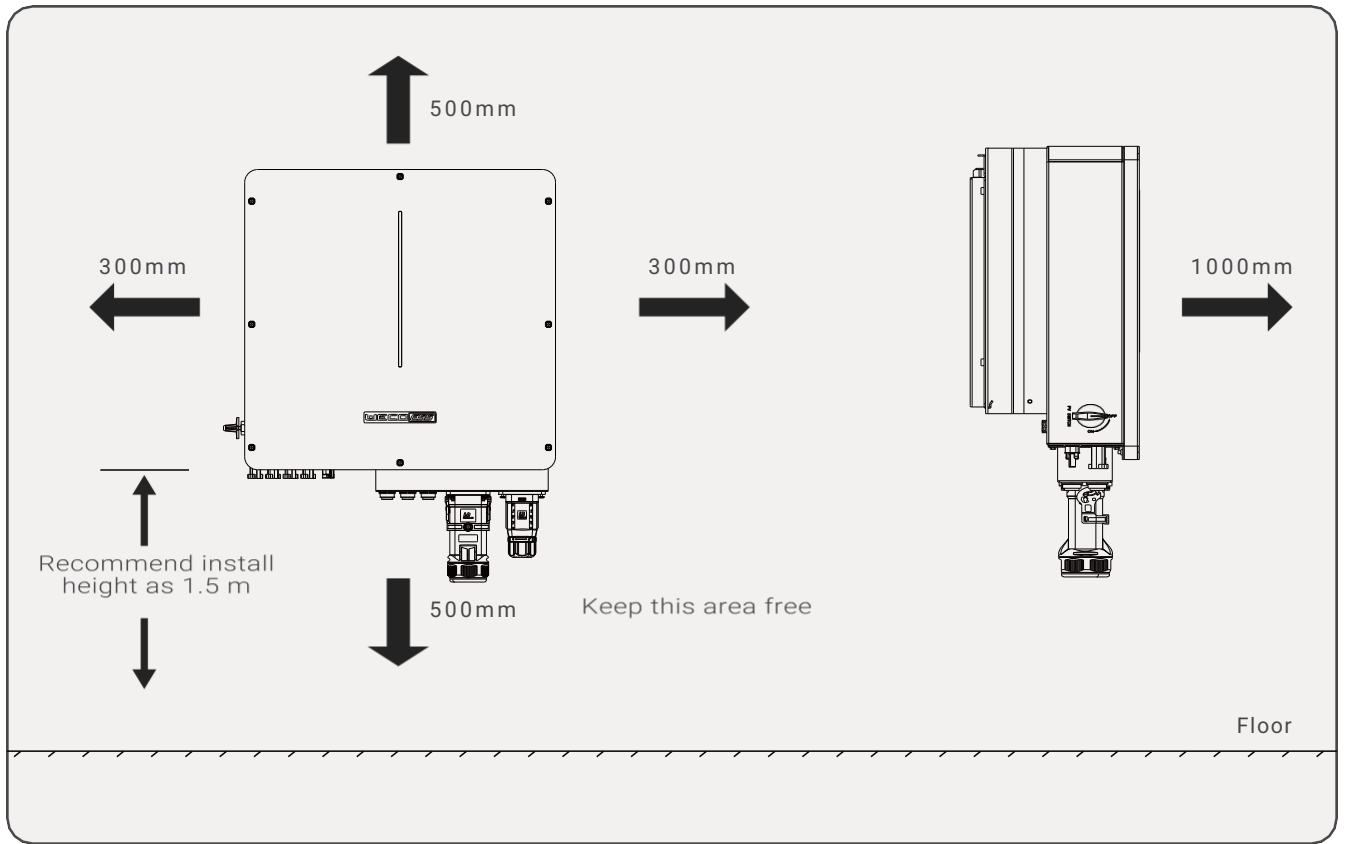

## 2 Install The Device

Use the bracket to locate the position of the holes on the wall.

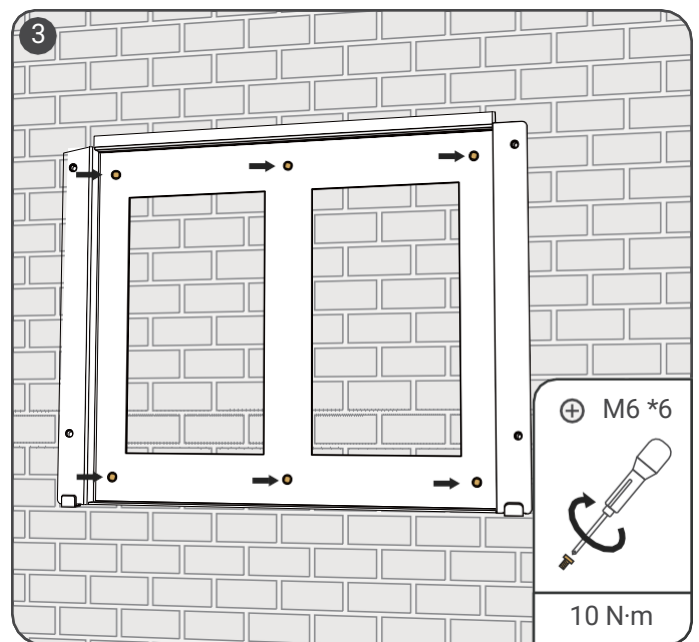
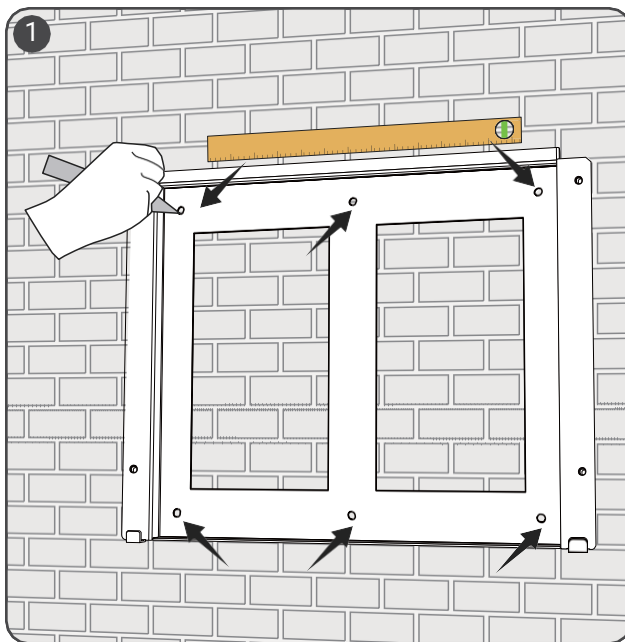

Drill the holes using a drill, install the expansion plugs and fix the bracket to the wall.

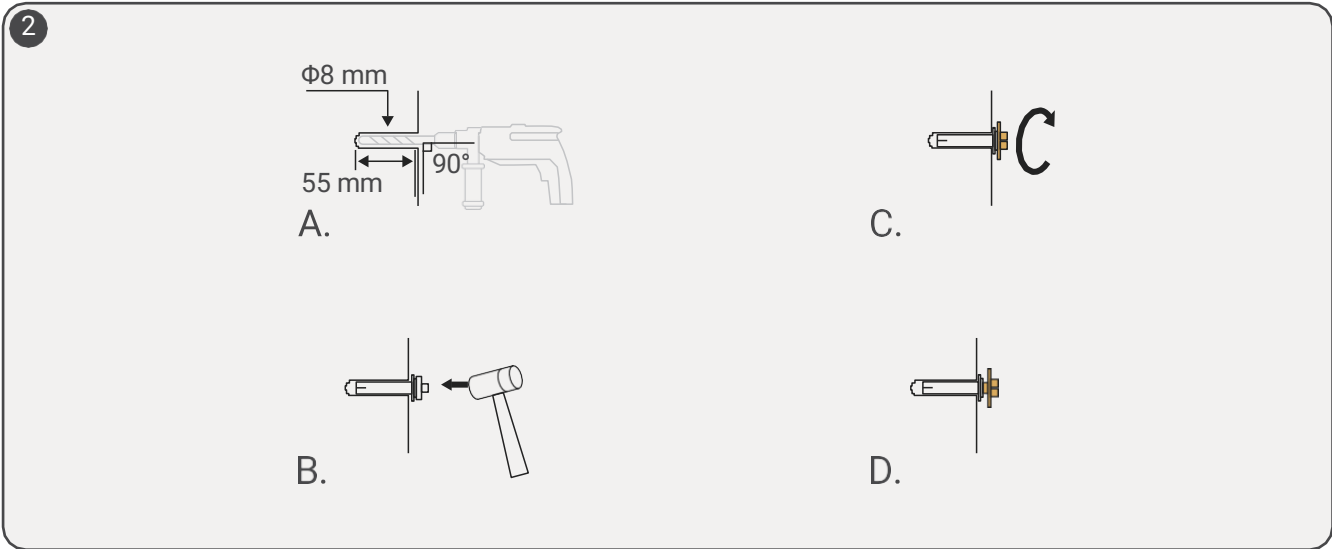

Install the bracket on the back of the inverter and mount the inverter on the wall bracket.

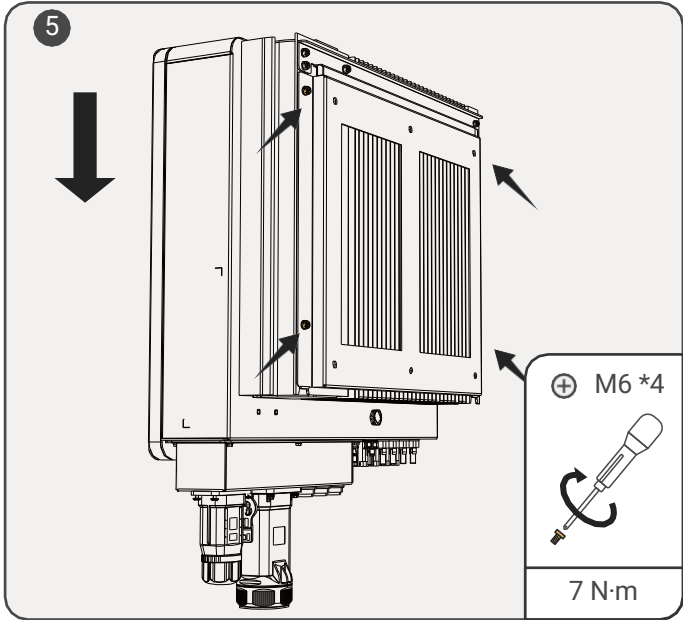
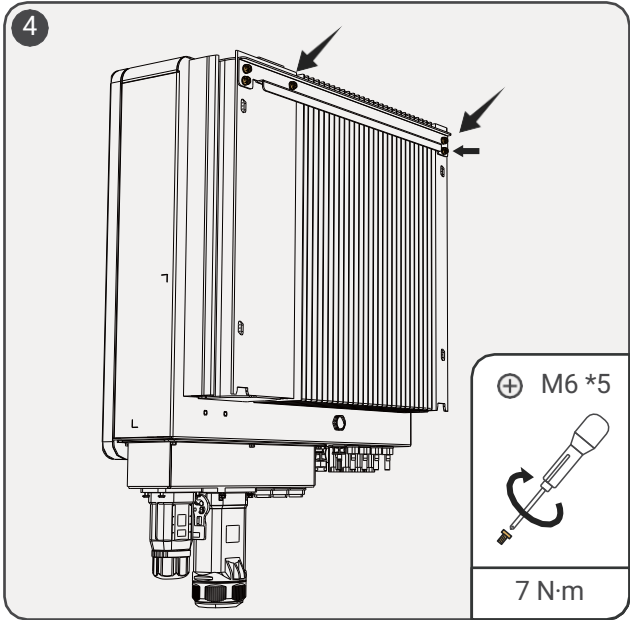

### 3 System Wiring

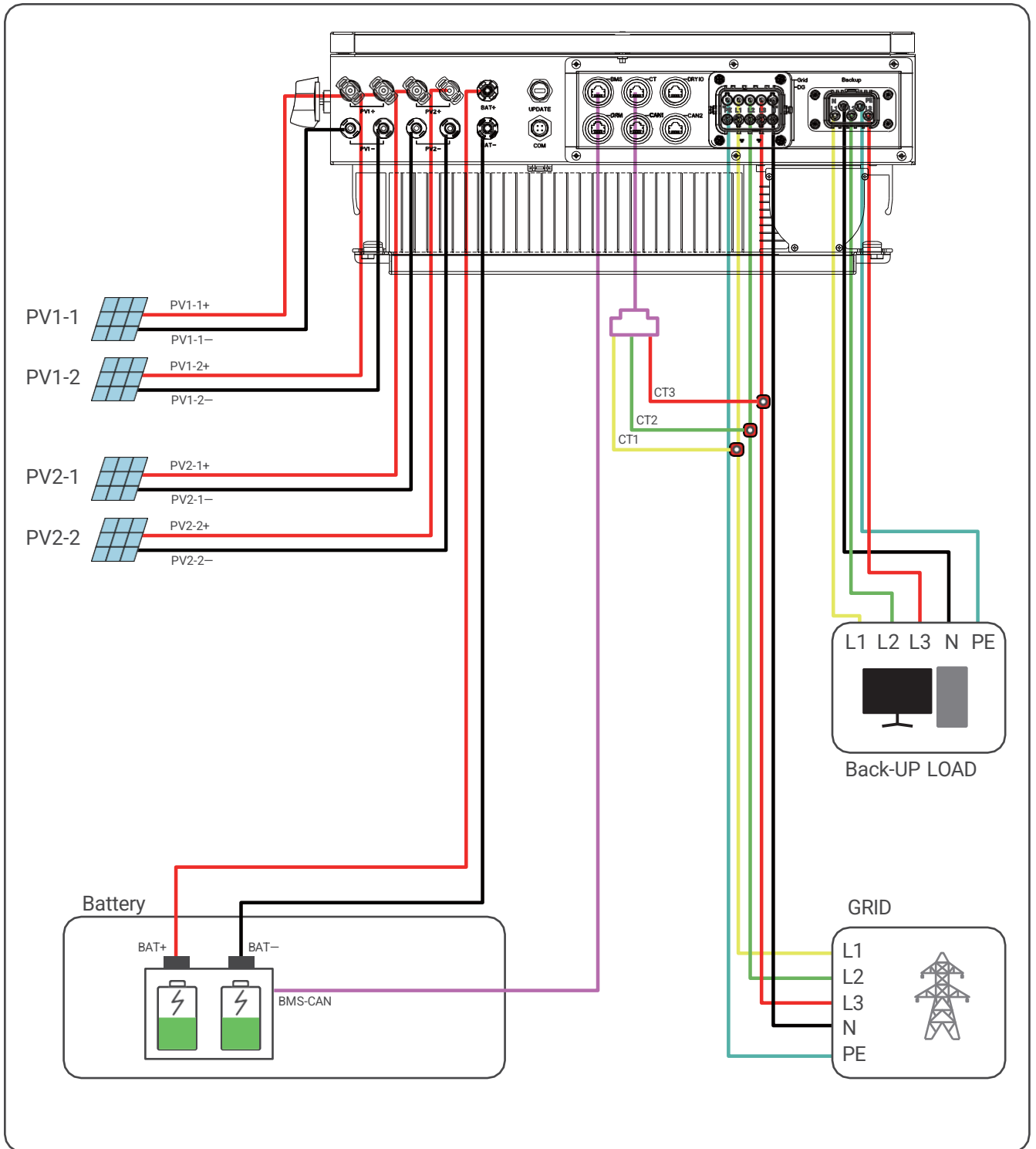

## 4 PE Cable Wiring

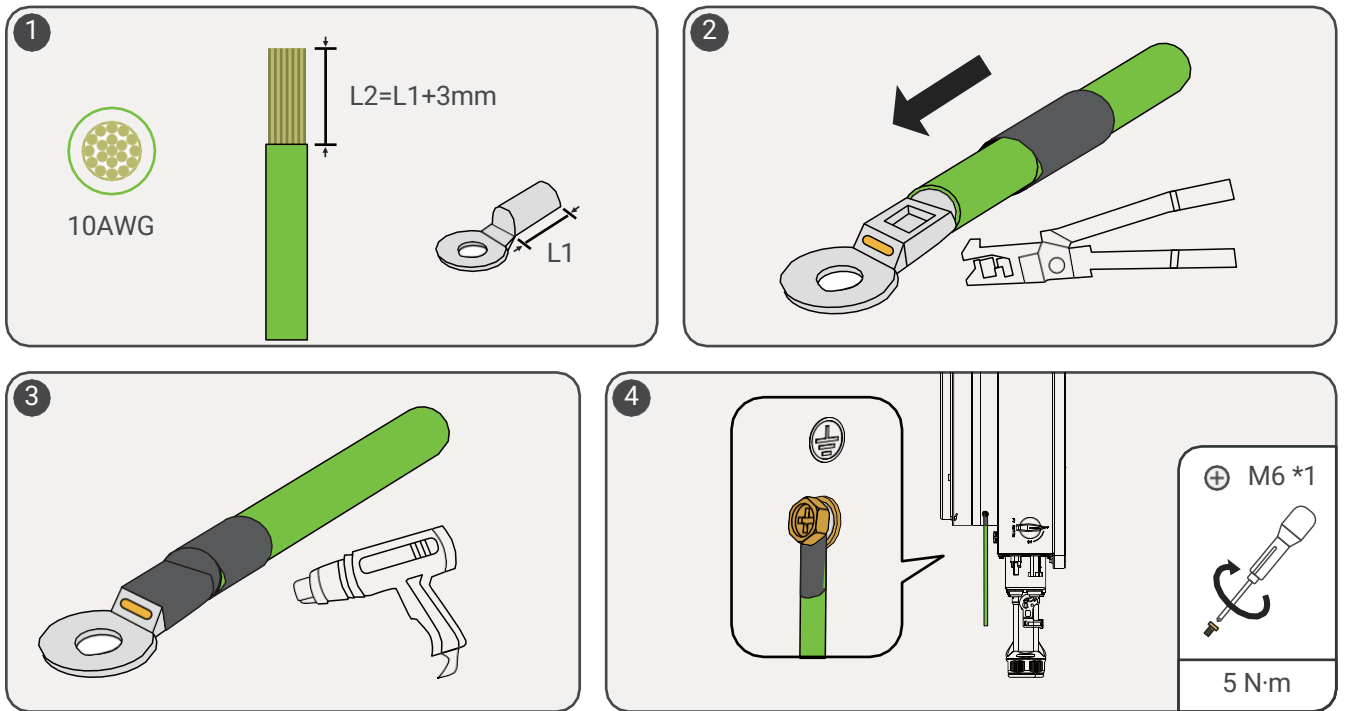

## 5 Back-UP Load Cable Wiring

The EPS port should be reserved for critical loads that are to be supplied in off-grid conditions. The maximum power of the port is equal to the nominal power of the inverter, however, it is recommended to limit the power to 80% if possible.

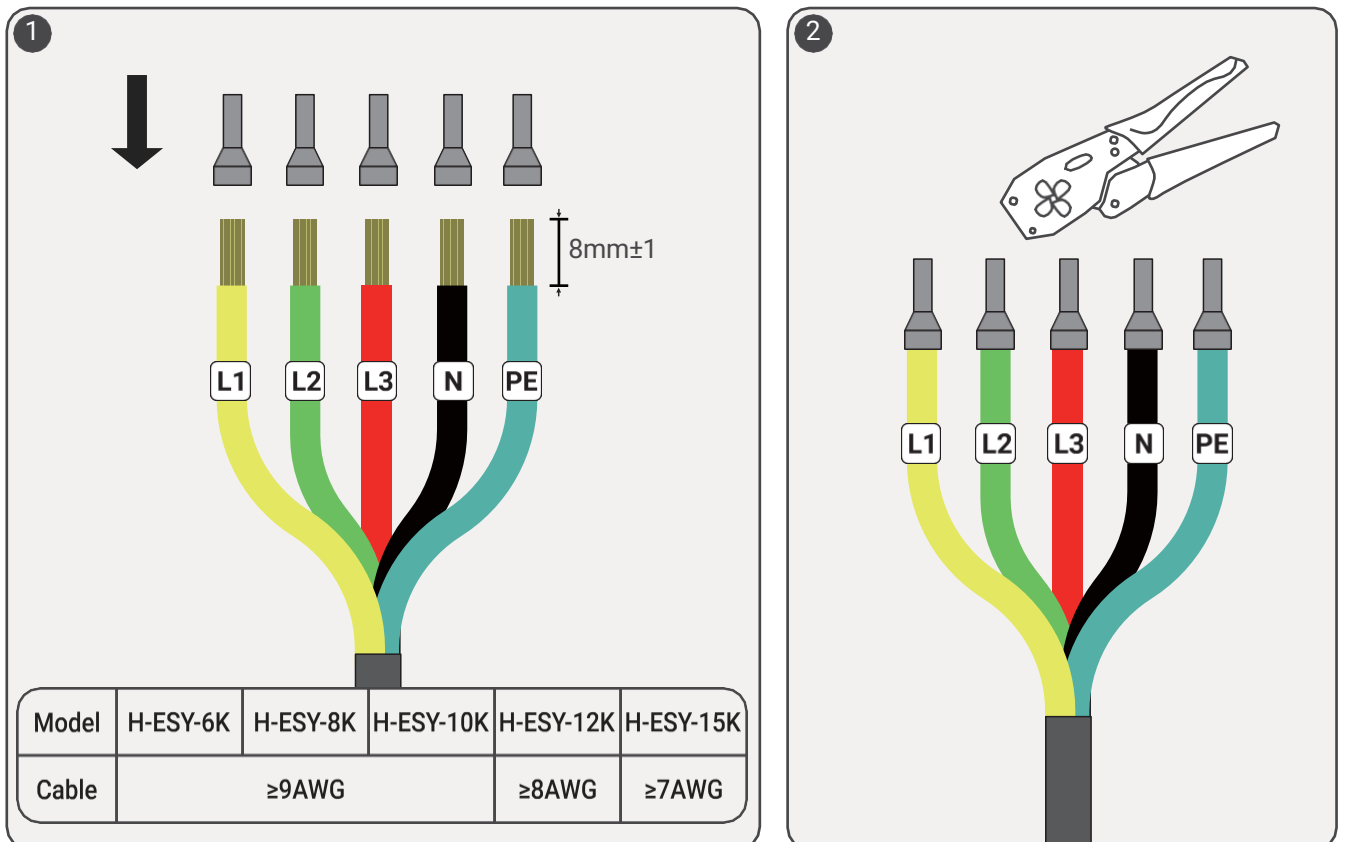

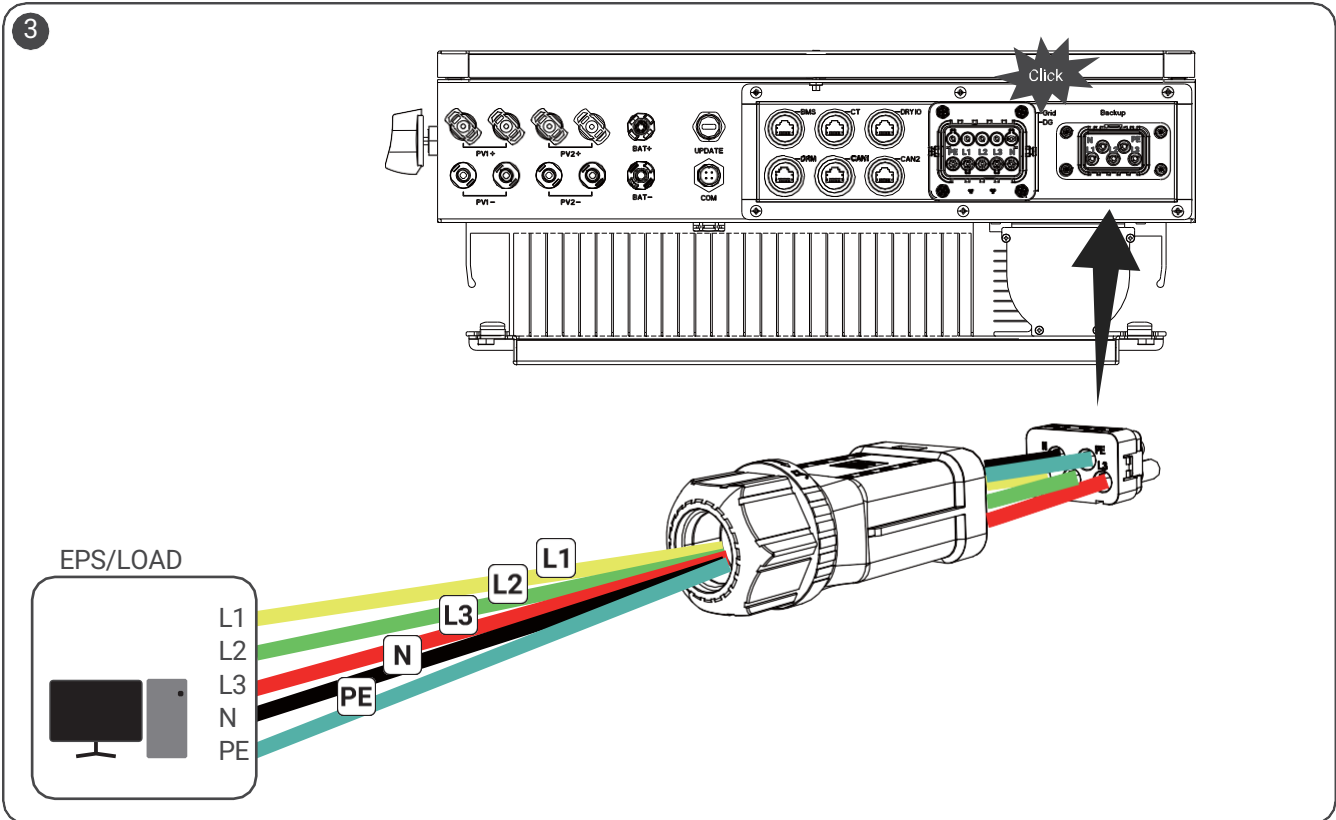

## 6 Grid cable Wiring

For the connection of network cables Weco can supply both CT and Meter, users can choose the corresponding solution according to their needs.

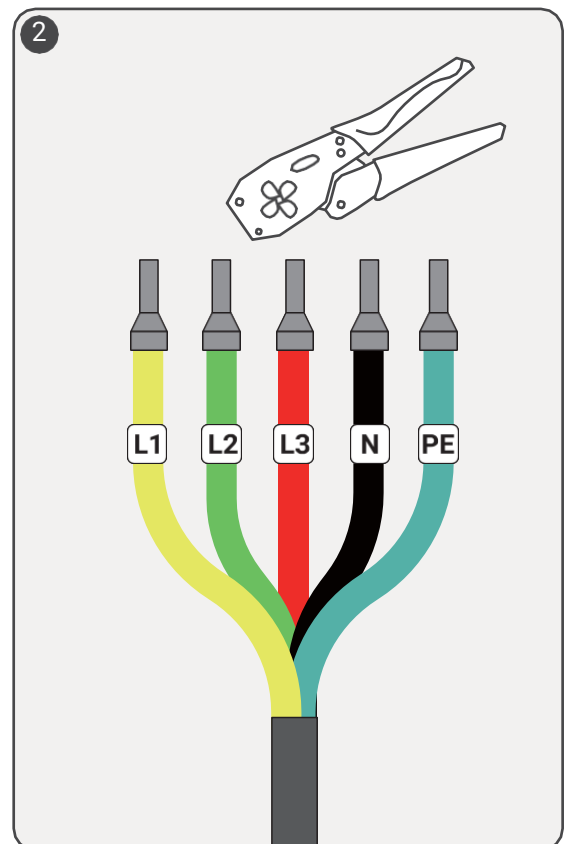
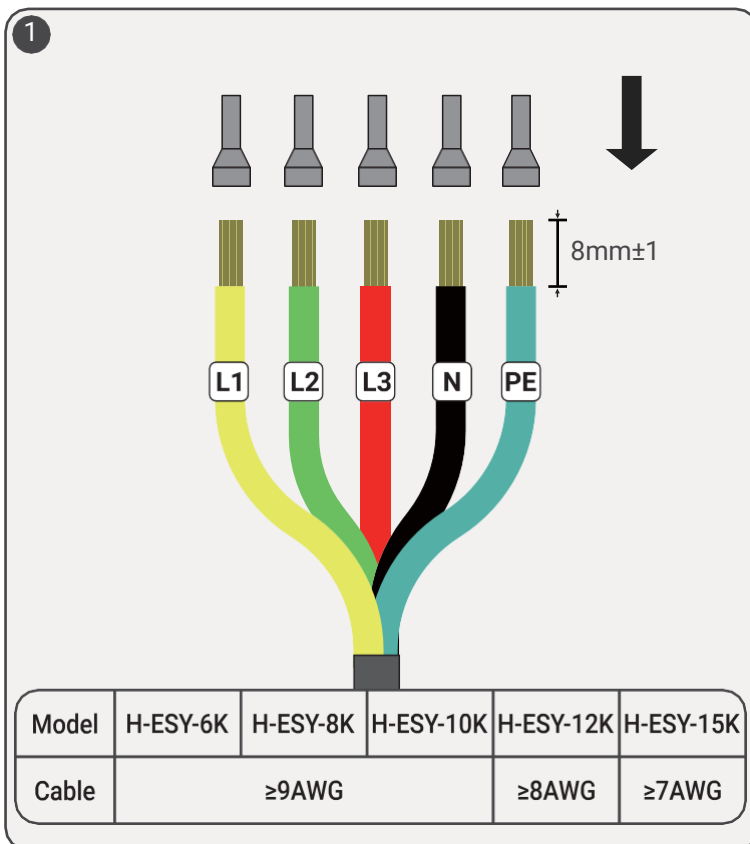

### 3 CT Wiring

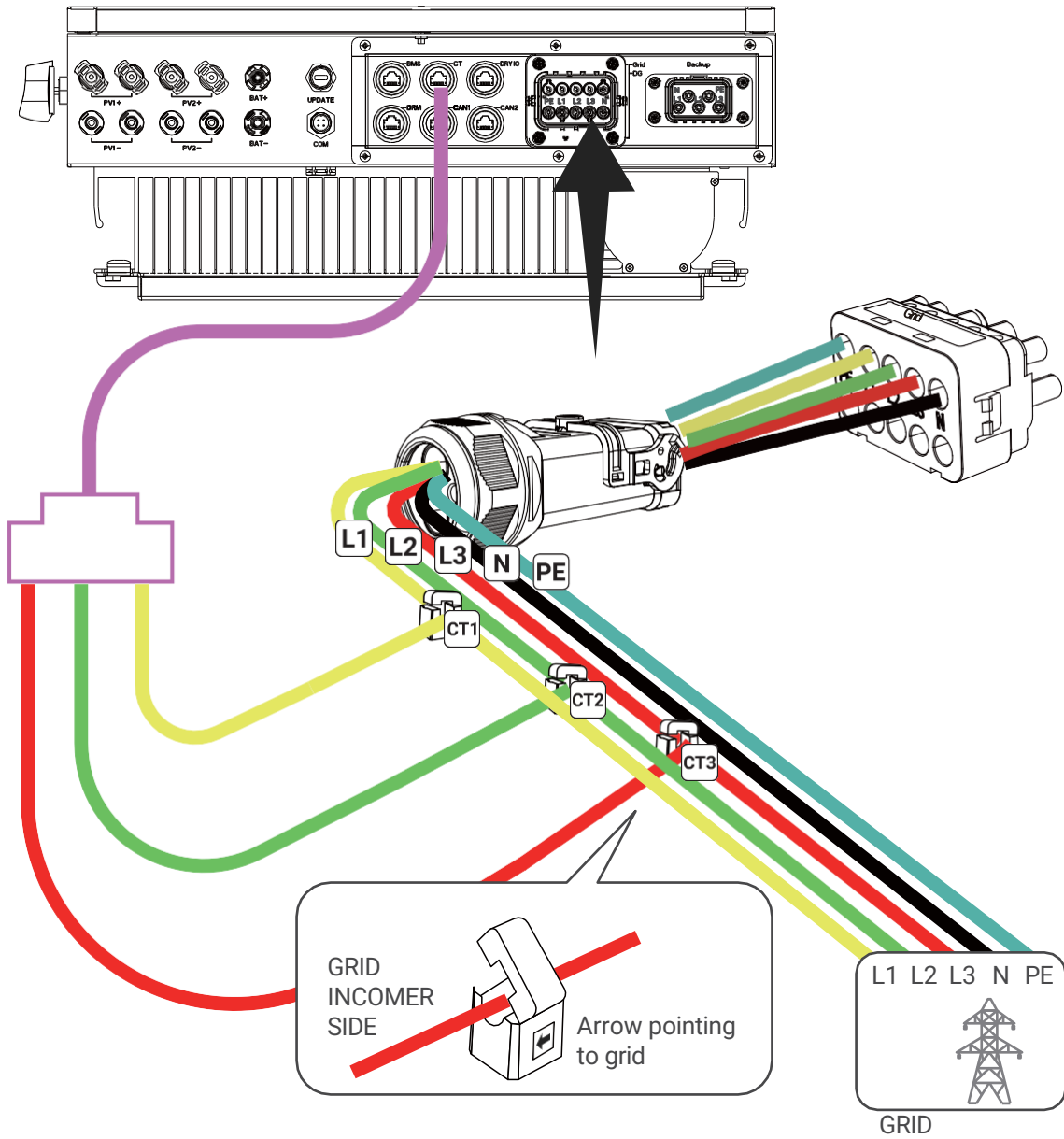

### 1 Meter Wiring(Optional)

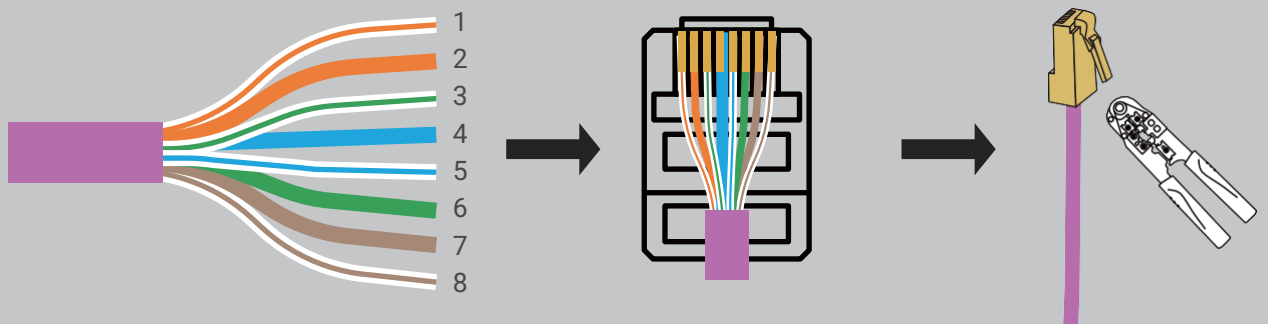

## 2 Meter Wiring(Optional)

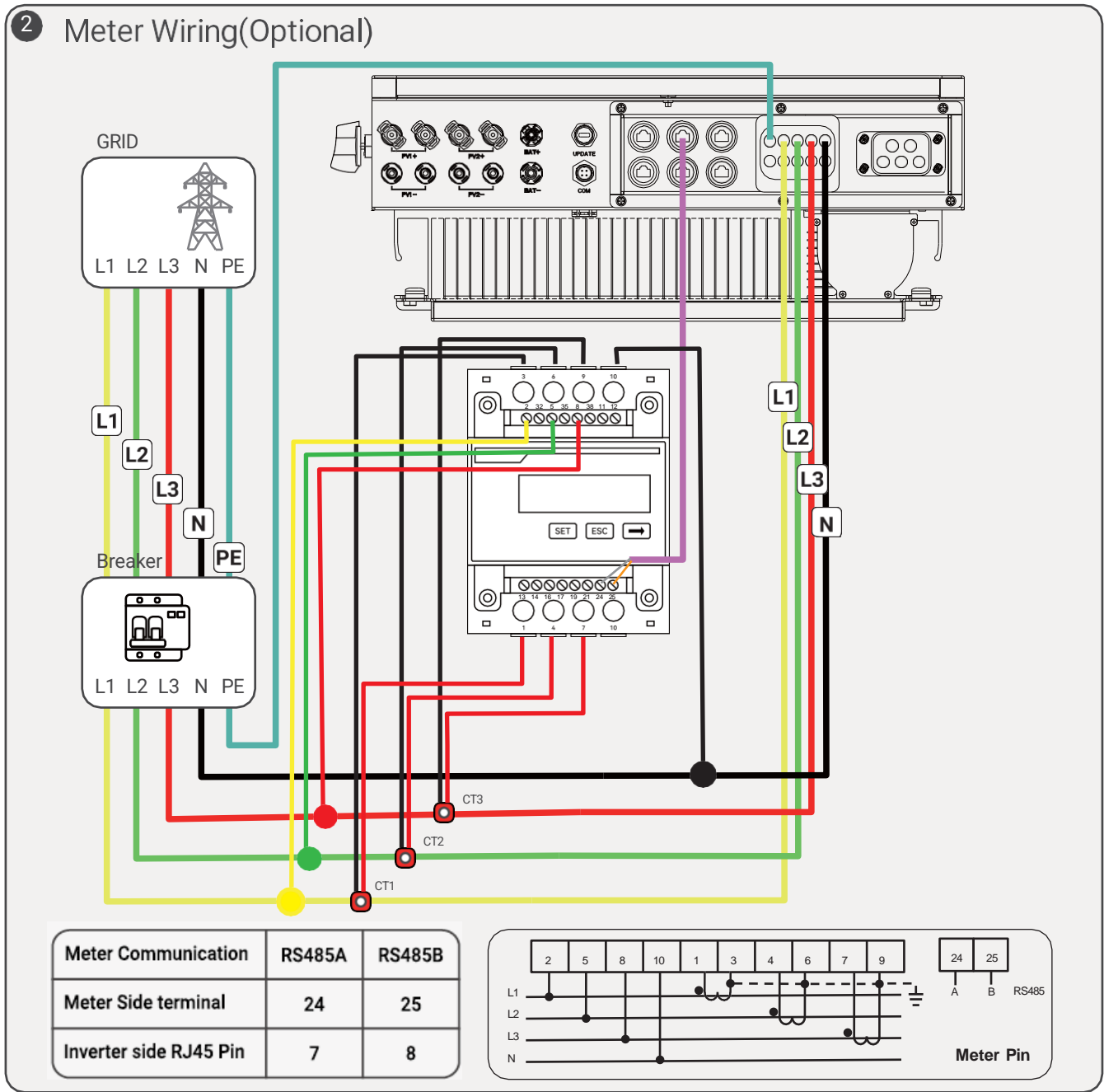

## 7 Battery cable Wiring

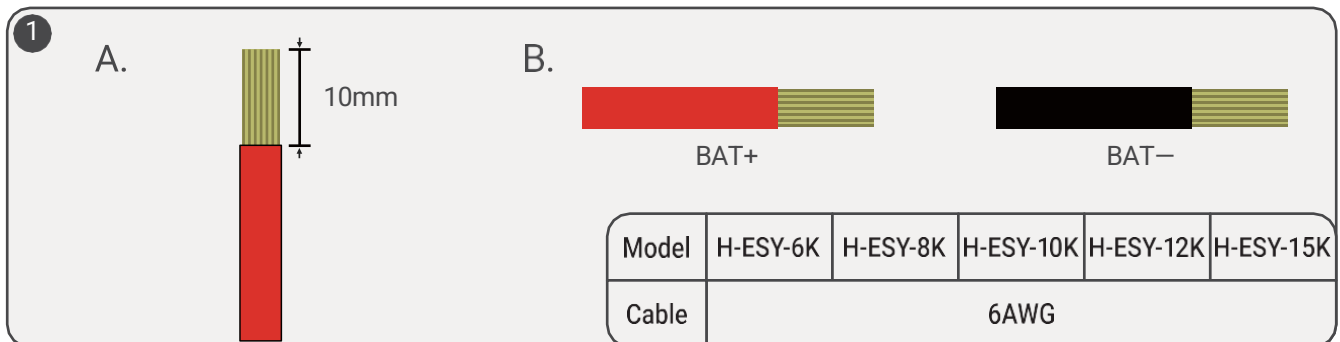



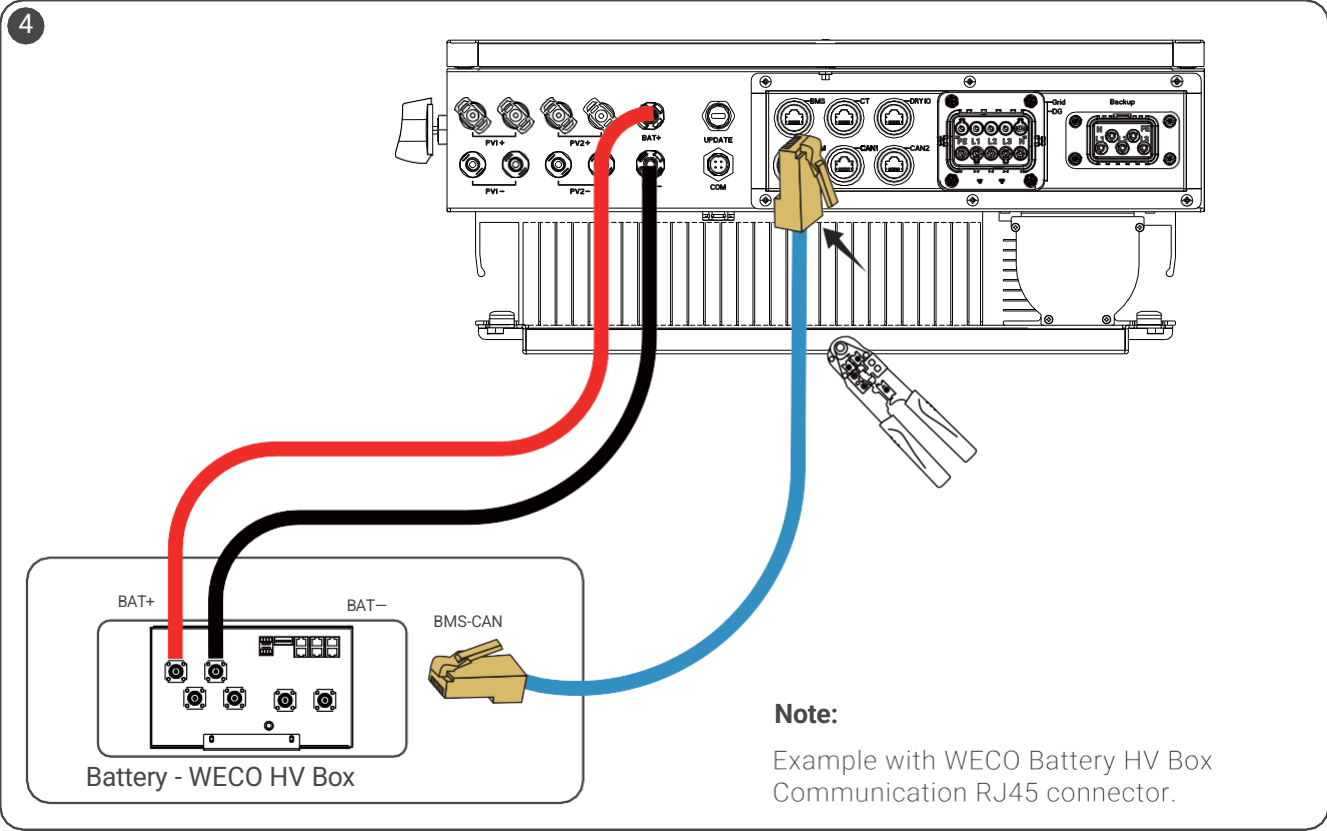
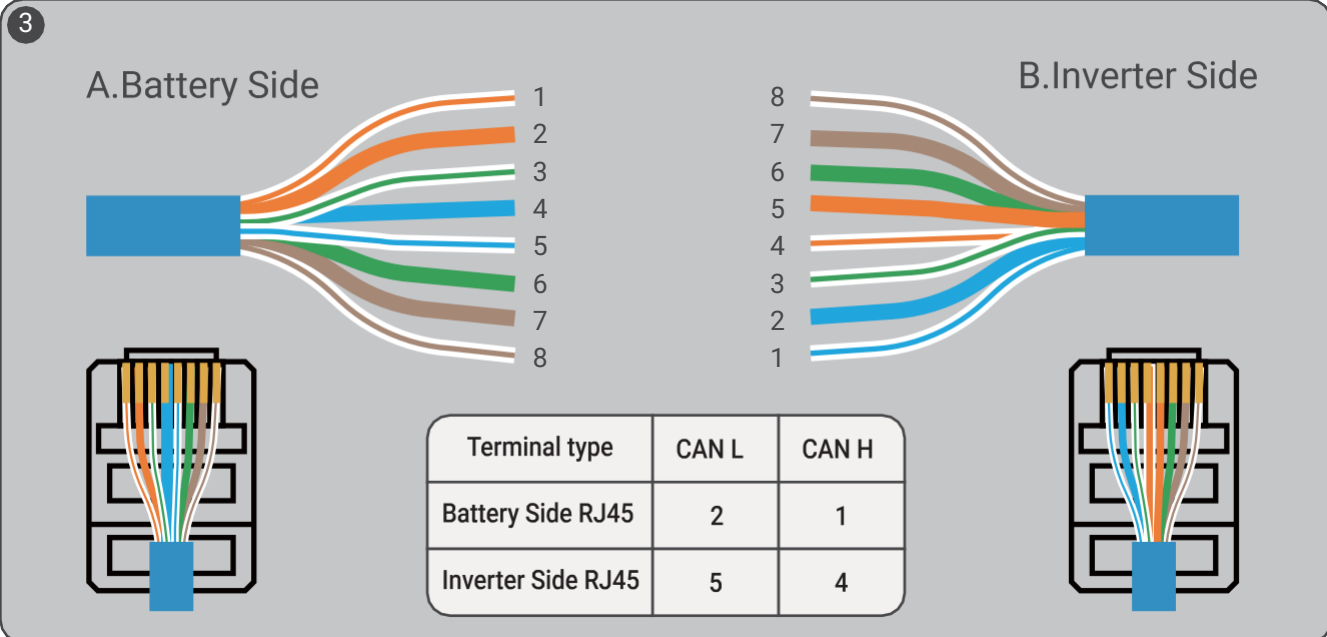
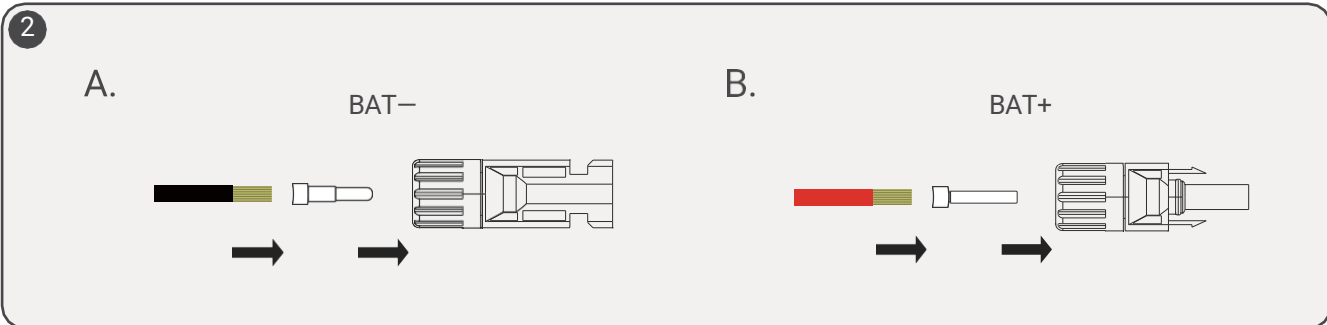

## 8 PV Cable Wiring

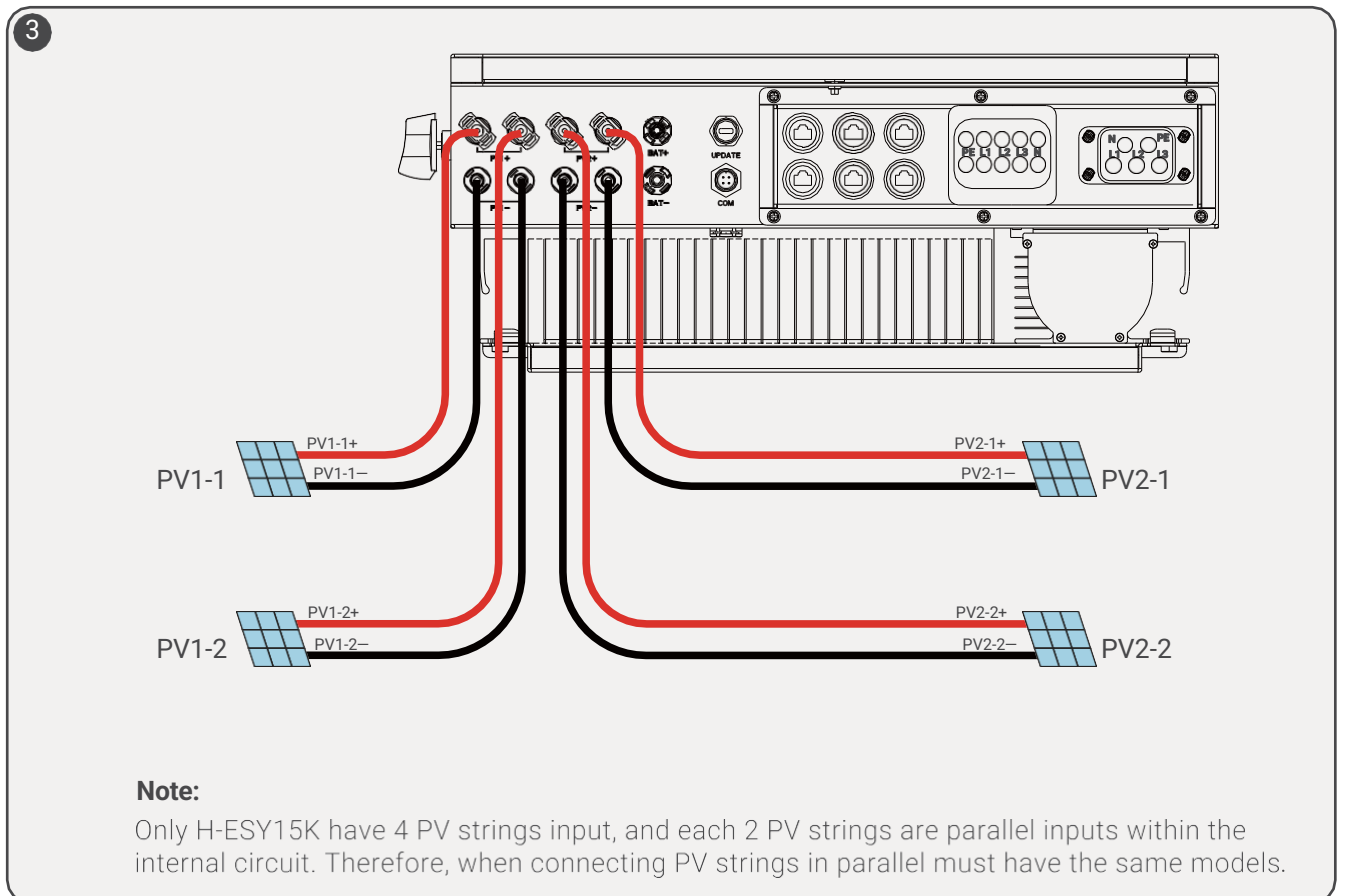
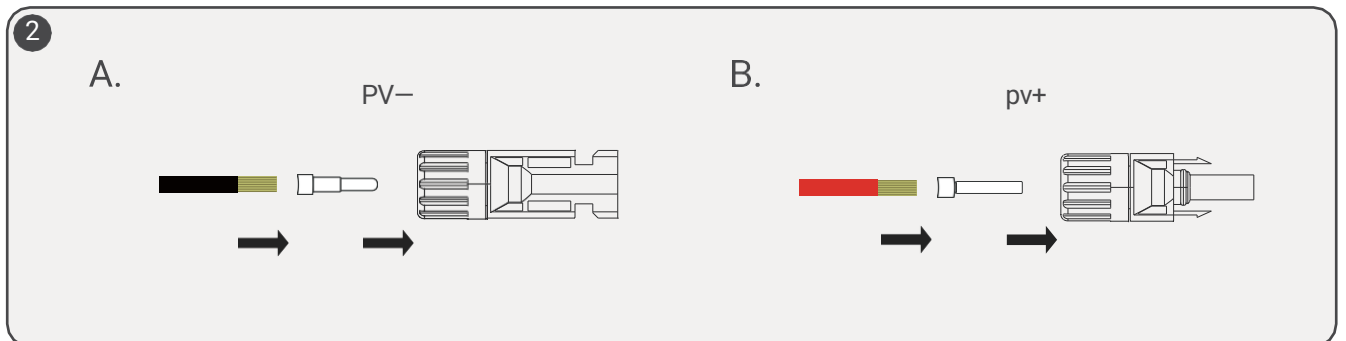
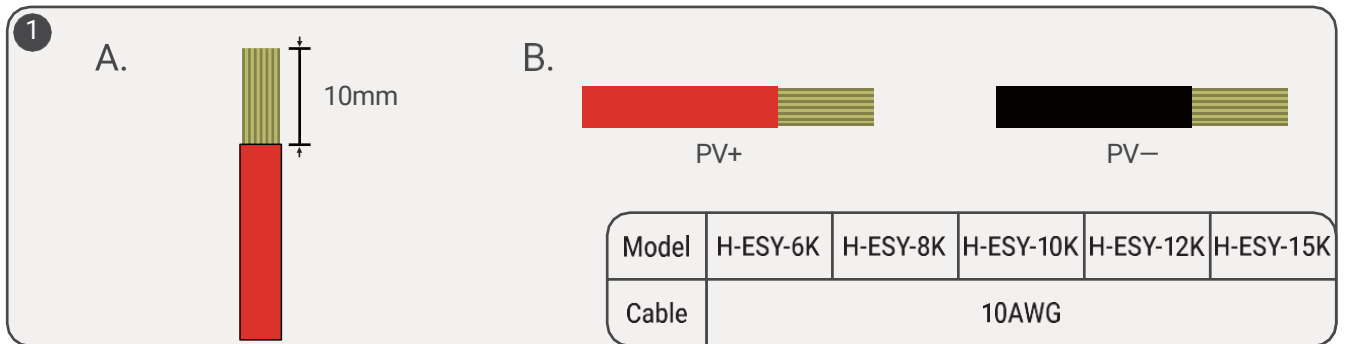

## 9 Install WIFI Module

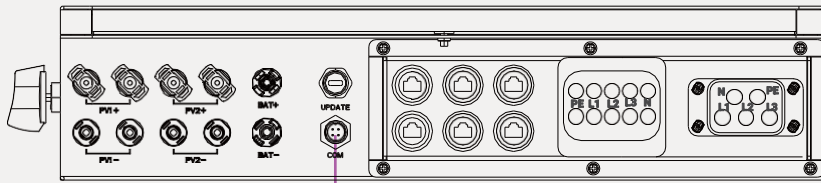

### Note:

The WI-FI module only support 2.4GHz WI-FI for remotely connection via WECO NOOR APP.  
Make sure the router can support 2.4GHz for inverter to work online.

## 10 Power the system and commission

1

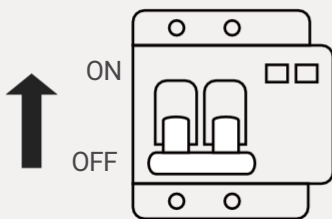

### Note:

- 1) Before powering on the system, confirm that the system installation and all wiring connections meet the requirements
- 2) Close the grid input switch first, then turn on the battery if it is an on-grid system;  
Turn on the battery if it is an off-grid system.

2



Download from Google or IOS app store

### Note:

- 1) Create an account to finish commission steps.
- 2) Follow the steps to finish Add Plant step and Add Device.
- 3) Finish the system setting according to the connection and user demand.

3

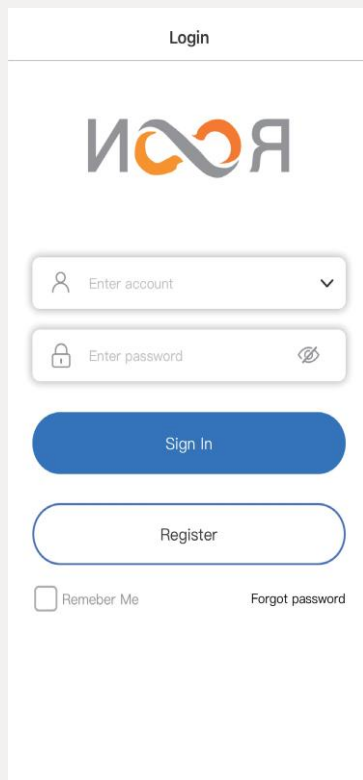

Register and Login in with user account

4

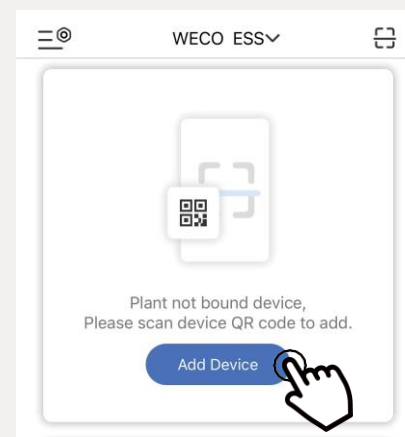
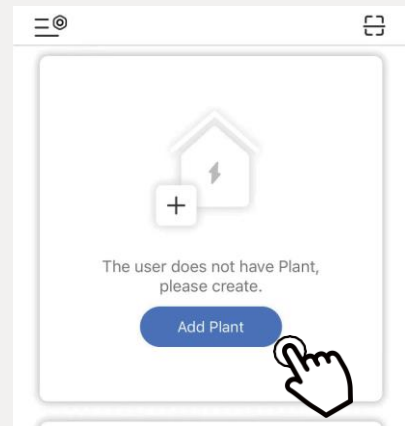

Add Plant and Add Device in the Plant

5

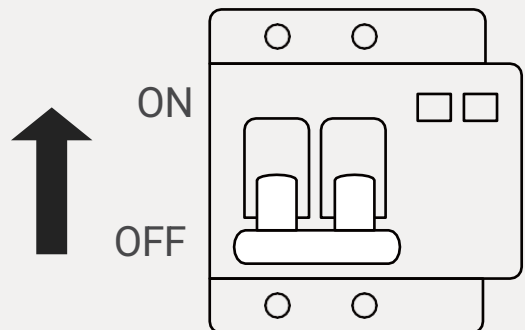
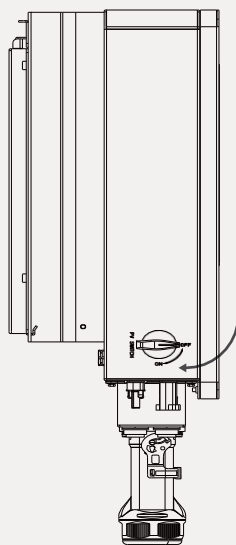

Energize the inverter PV and Battery